

4.18. Phased stocktakes

General

Phased stocktakes are commonly carried out in larger warehouses. In this type of stocktake, stocktakes are created for each aisle and level combination in the warehouse. When a stocktake is finalised then a new stocktake is created from it containing only the lines with discrepancies. When the third count is finalised then adjustments are made to make the stock in mSupply match any discrepancies. Thus, there is a maximum of 3 phases for each stocktake.

Setup

Store preferences

Before using phased stocktakes you must tell mSupply which parts of your shelf location codes (see the [4.06. Stock locations and location types](#) page for details) represent the aisle, level and position of the location (aisle = rack, level = horizontal level within the rack, position = vertical 'column' within the rack).

See the [26.07. Virtual stores](#) page for details on how this is set.

Confirm Customer Invoices

mSupply will not allow stock that is on a Customer Invoice with status of new (nw) or suggested (sg) to be taken out of stock by *any* other transaction process, including an inventory adjustment flowing from a stocktake - refer [Creating inventory adjustments](#).



It is **HIGHLY RECOMMENDED** to process (take the stock off the shelves) and confirm any customer invoices with a status of new (nw) or suggested (sg) *before* doing a stocktake - please see [Issuing Goods to a Customer \(Customer Invoices\)](#), [Confirming an invoice](#) for details on how to do that.

This is so important that mSupply will show you a warning message when you try to create a new stocktake if it detects any customer invoices with suggested status. Please read the warning and take suitable action.

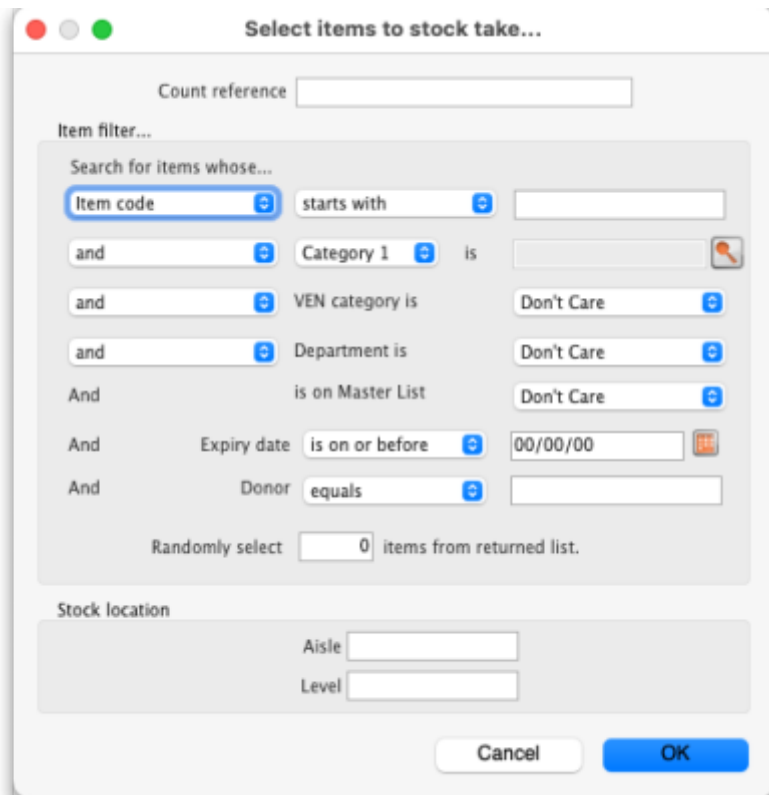

- **Count reference:** This is mandatory and is the unique reference for this phased stocktake (that is, the collection of all the individual stocktakes that makeup this one). It must be unique so you will be shown an alert if it isn't.
- **Item filter:** Make settings here to select the stock that is included in the stocktake. The filters work the same as for standard stocktakes as described on the [4.17. Stocktakes](#) page.
- **Stock location:** Here you can select a particular aisle or level of the warehouse to include in the stocktake. Enter the identifier of an aisle in the **Aisle** textbox or the identifier of a level in the **Level** textbox:
 - If you enter an **Aisle** value only, then a stocktake will be created for each level in that aisle.
 - If you enter a **Level** value only, then a stocktake will be created for that level in each aisle in the warehouse.
 - If you enter an **Aisle** and **Level** value then a single stocktake will be created for the level in the aisle specified.
 - If you enter neither value then a stocktake will be created for every level in every aisle in the warehouse.

When you click on the **OK** button mSupply will create a stocktake for each level in each aisle you have selected to be included in the phased stocktake. Each stocktake will contain one line for each line of stock found in a location that belongs to the aisle/level combination that the stocktake is for.

When the stocktake creation is complete you will be told how many stocktakes were created in an alert message. When you close the message, the stocktakes will be displayed in the table like this:



The reference in the *Reference* column is constructed as Count reference-Number-Aisle-Level/Phase where:

- Count reference is the **Count reference** value entered in the stocktake options
- Number is an incrementing number starting at 1 and padded to 5 digits with leading zeroes
- Aisle is the aisle this stocktake is for
- Level is the level this stocktake is for
- Phase is the phase of this stocktake, a number from 1 to 3

Carrying out a phased stocktake

To open a phased stocktake, double click on it in the list. The stocktake detail window is opened:

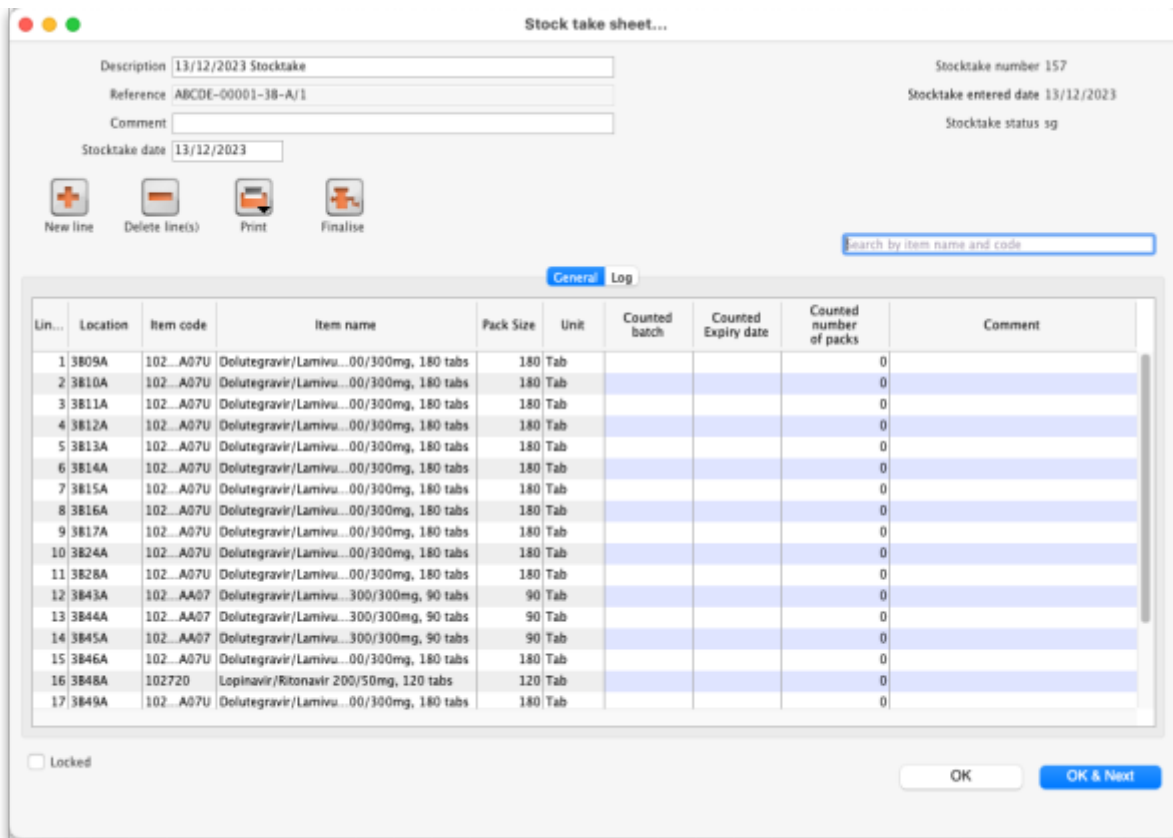

- **Description:** An editable description of the stocktake. Set to the date the stocktake was created followed by “Stocktake” by default
- **Reference:** The count reference, read only
- **Comment:** Enter anything you need to remember about this stocktake
- **Stocktake date:** the date the stocktake count was started, set to the creation date by default

Print the count sheets

The next thing to do is to print out the count sheets so that the warehouse operatives can take them into the warehouse to carry out the count. At this stage, when the stocktake is at sg (suggested) status, this is the only thing you can print and it looks like this:

Count Type	3B
Level	A

Stock count reference	ABCDE
Stock count sheet	00001/1

Date: 13/12/2023
Page 1 of 2

Emplace	Code	Description	Lot #	Peremption	Quantite	Unite de Sortie
3B01A						
3B02A						
3B03A						
3B04A						
3B05A						
3B06A						
3B07A						
3B08A						
3B09A	102762AAA07U	Dokutearavir/Lamivudine/Tenofovir 50/300/300mg, 180 tabs				Tab
3B10A	102762AAA07U	Dokutearavir/Lamivudine/Tenofovir 50/300/300mg, 180 tabs				Tab
3B11A	102762AAA07U	Dokutearavir/Lamivudine/Tenofovir 50/300/300mg, 180 tabs				Tab
3B12A	102762AAA07U	Dokutearavir/Lamivudine/Tenofovir 50/300/300mg, 180 tabs				Tab
3B13A	102762AAA07U	Dokutearavir/Lamivudine/Tenofovir 50/300/300mg, 180 tabs				Tab
3B14A	102762AAA07U	Dokutearavir/Lamivudine/Tenofovir 50/300/300mg, 180 tabs				Tab
3B15A	102762AAA07U	Dokutearavir/Lamivudine/Tenofovir 50/300/300mg, 180 tabs				Tab
3B16A	102762AAA07U	Dokutearavir/Lamivudine/Tenofovir 50/300/300mg, 180 tabs				Tab
3B17A	102762AAA07U	Dokutearavir/Lamivudine/Tenofovir 50/300/300mg, 180 tabs				Tab
3B18A						
3B19A						
3B20A						
3B21A						
3B22A						
3B23A						
3B24A	102762AAA07U	Dokutearavir/Lamivudine/Tenofovir 50/300/300mg, 180 tabs				Tab
3B28A	102762AAA07U	Dokutearavir/Lamivudine/Tenofovir 50/300/300mg, 180 tabs				Tab
3B29A						
3B30A						



NOTE: When the **Reference** value ends in /1 the count sheets contain a line for every location in the aisle/level combination this stocktake is for. These are the blank lines with a value only in the *Location* (Emplace) column. When the **Reference** value ends in /2 or /3 then only lines in the stocktake are printed.

Using the count sheets, the warehouse operatives count the stock in the warehouse.

After counting the stock

After counting the stock, the count sheets are brought back to mSupply and the information is entered into the stocktake.

The stocktake is completely blind so the batch, expiry date and number of packs of each line entered on the count sheets should be entered in the *Counted batch*, *Counted Expiry date* and *Counted number of packs* columns. Optionally, you can enter a value in the *Comment* column if there is something you need to remember about this line.

To enter something in one of the columns, simply click into it and type what you want to enter. If you need to enter more than the batch, expiry date, number of packs or comment then double-click on the line to make more fields available for entry:

- **Counted number of packs:** The number of packs counted on the shelf
- **Pack size:** The number of units that are in a pack
- **Batch:** The batch of the stock
- **Expiry date:** The expiry date of the stock. Enter is manually or select it by clicking on the calendar button
- **Location:** The location the stock was found in. Type the first few characters of the location and press the *Tab* key to select the location from a list of locations that begin with what you typed (if there is only one that matches then it will be selected and filled in for you)
- **Donor:** The donor of this stock (only shown if the option to track donor is turned on - see the [16.03. Invoice preferences](#) page for details). Type the first few characters of the donor's name and press the *Tab* key to select the location from a list of locations that begin with what you typed (if there is only one that matches then it will be selected and filled in for you)
- **Cost price:** The cost price of one pack
- **12 month average checkbox:** Check this to replace the cost price with an average of the cost prices for stock of the same item received in the last 12 months
- **Sell price:** The sell price of one pack

If a new line of stock was found which isn't in mSupply then add it using the **New line** button (see the [Add a new line to a stocktake](#) section below for details).

When all the count sheet details have been entered into the stocktake and checked, it is time to finalise the stocktake. To do this, click on the **Finalise** button. After confirming that you want to finalise the stocktake, this will do two things:

1. The stocktake will be made read-only and no further changes can be made to it.
2. If there are any discrepancies between the the batch, expiry date or number of packs that were entered for a line and the actual batch, expiry date or number of packs of the stock line in mSupply then:
 1. if the **Reference** value of the stocktake ends in /1 or /2, a new stocktake containing only the lines that showed a discrepancy is created. This stocktake will have the same reference value as this stocktake except that its phase number will be incremented by 1. So, if the **Reference** ended in /1, the new stocktake's reference will end in /2, if it ended in /2 then the new stocktake's reference will end in /3.
 2. if the **Reference** value of the stocktake ends in /3 then inventory adjustments are created to make the stock of the lines with discrepancies match what was counted in the stocktake. Note: any lines that only have a discrepancy in the batch or expiry date will not appear in an inventory adjustment but the changes will be made and logged.

If there are no differences between the batch, expiry date or number of packs that were entered for all lines and the actual batch, expiry date or number of packs of the matching stock lines in mSupply then nothing further is done and the user is shown an alert message to say that the count for this aisle/level combination is complete.



Note that a line that has had nothing entered for it in the stocktake is counted as having a discrepancy and will appear in a further stocktake or an inventory adjustment after a stocktake has been finalised.

Add a new line to the stocktake

To add a new line to the stocktake (for stock that you find during the stocktake that is not in mSupply already), click on the **New line** button. This window will open:

Enter the first few characters of the item the stock is for in the **Item** text box and press the *Tab* key on the keyboard to select the right item from a list of items beginning with what you typed (if there is only one item that matched it will be selected for you and entered in the **Item** text box).

Now enter the details of the stock in the *New stock line* section:

- **Counted number of packs:** The number of packs counted on the shelf
- **Pack size:** The number of units that are in a pack
- **Batch:** The batch of the stock
- **Expiry date:** The expiry date of the stock. Enter is manually or select it by clicking on the calendar button
- **Location:** The location the stock was found in. Type the first few characters of the location and press the *Tab* key to select the location from a list of locations that begin with what you typed (if there is only one that matches then it will be selected and filled in for you)
- **Donor:** The donor of this stock (only shown if the option to track donor is turned on - see the [16.03. Invoice preferences](#) page for details). Type the first few characters of the donor's name and press the *Tab* key to select the location from a list of locations that begin with what you typed (if there is only one that matches then it will be selected and filled in for you)

- **Cost price:** The cost price of one pack
- **12 month average checkbox:** Check this to replace the cost price with an average of the cost prices for stock of the same item received in the last 12 months
- **Sell price:** The sell price of one pack

When you've added all the details click on the **Add new** button to add the line to the stocktake. It will appear at the bottom of the table of stocktake lines.

Delete a line from the stocktake

To delete one or more lines from the stocktake, select them in the table and click on the **Delete line(s)** button. After confirmation the selected lines will be deleted.

Please note, you can only delete lines from the stocktake that you manually added to it using the **New line** button.

After finalising a stocktake

After finalising a stocktake the stocktake becomes read-only but you can now print out an *In progress stock count sheet* from the **Print** button. This is what it looks like:

Stock Count Sheet (in progress)

Count ref: ABCDE Aisle: 3B Date: 13/12/2023
 Count ID: 00001 Time: 17:30:01 Page 1 of 1

Location	Product	Description	Batch	Pack size	Original Qty	Count Qty	Variance (QTY)
3B09A	102762AAA07U	Dolutedegravir/Lamivudine/Tenofovir 50/300/300mg, 180 tabs	eresnesr	180	720	50	670
3B10A	102762AAA07U	Dolutedegravir/Lamivudine/Tenofovir 50/300/300mg, 180 tabs	sdasds	180	768	90	678
3B11A	102762AAA07U	Dolutedegravir/Lamivudine/Tenofovir 50/300/300mg, 180 tabs		180	768	0	768
3B12A	102762AAA07U	Dolutedegravir/Lamivudine/Tenofovir 50/300/300mg, 180 tabs		180	768	0	768
3B13A	102762AAA07U	Dolutedegravir/Lamivudine/Tenofovir 50/300/300mg, 180 tabs		180	768	0	768
3B14A	102762AAA07U	Dolutedegravir/Lamivudine/Tenofovir 50/300/300mg, 180 tabs		180	768	0	768
3B15A	102762AAA07U	Dolutedegravir/Lamivudine/Tenofovir 50/300/300mg, 180 tabs		180	768	0	768
3B16A	102762AAA07U	Dolutedegravir/Lamivudine/Tenofovir 50/300/300mg, 180 tabs		180	768	0	768
3B17A	102762AAA07U	Dolutedegravir/Lamivudine/Tenofovir 50/300/300mg, 180 tabs		180	768	0	768
3B24A	102762AAA07U	Dolutedegravir/Lamivudine/Tenofovir 50/300/300mg, 180 tabs		180	768	0	768
3B28A	102762AAA07U	Dolutedegravir/Lamivudine/Tenofovir 50/300/300mg, 180 tabs		180	768	0	768
3B43A	102762AAA07U	Dolutedegravir/Lamivudine/Tenofovir 50/300/300mg, 90 tabs		90	2400	0	2400

When you finalise the last stocktake with the same **Count reference** (as entered in the options window when creating the phased stocktake) then you will be asked if you want to print out the *Stock comparison report*, which will show you all the discrepancies recorded in all the stocktakes with the same count reference.

Previous: [4.17. Stocktakes](#) | | Next: [4.19. Inventory adjustments](#)

From:

<https://docs.msupply.org.nz/> - **mSupply documentation wiki**

Permanent link:

https://docs.msupply.org.nz/items:phased_stocktakes?rev=1702489132

Last update: **2023/12/13 17:38**

